

MACHINING TOLERANCES

Connecting rods probably receive the highest stresses of any bottom end engine component. The forces the rod receives when the piston direction reverses from top dead center can exceed 12,000 lb. in a 500 C.I. Pro Stock engine. This is why Lunati rods are forged from the finest premium quality 4340 alloy steel for strength and utilize Lunati/ARP rod bolts for superior clamping forces on the rod journal.

Closer tolerances and pride in workmanship, along with strict quality control are what makes Lunati Connecting Rods the only logical choice for serious racers. We at Lunati feel the no other manufacturer will hold the close machining tolerances in manufacturing that we do.

OUR TOLERANCES SPEAK FOR THEMSELVES!

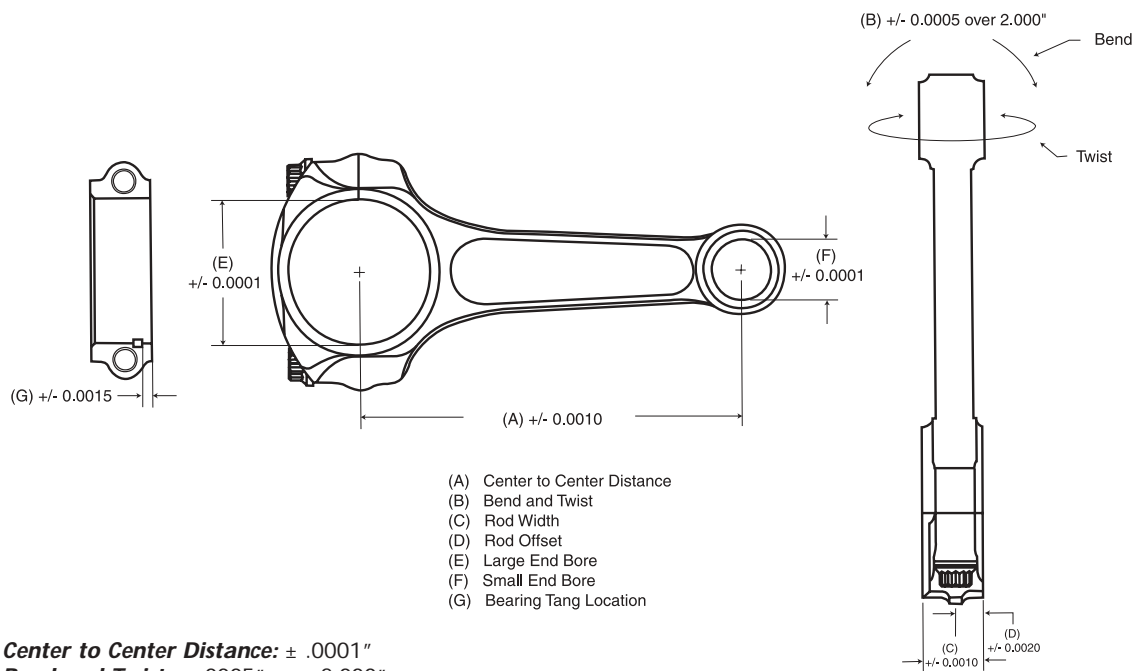

- Center to Center Distance:** $\pm .0001$ "
- Bend and Twist:** $\pm .0005$ " over 2.000"
- Rod Width:** $\pm .001$ "
- Rod Offset:** $\pm .002$ "
- Large End Bore:** $\pm .0001$ "
- Small End Bore:** $\pm .0001$ "
- Bearing Tang Location:** $\pm .0015$ "

NOTE: Tolerances shown are for Pro Billet & Pro Mod rods